

MANUAL FOAM SOAP DISPENSER INSTALLATION

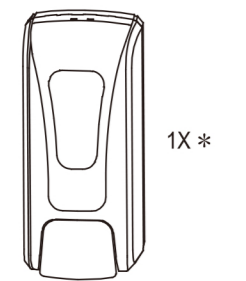

1X *



* we have different shape but same installation.

A Packing List

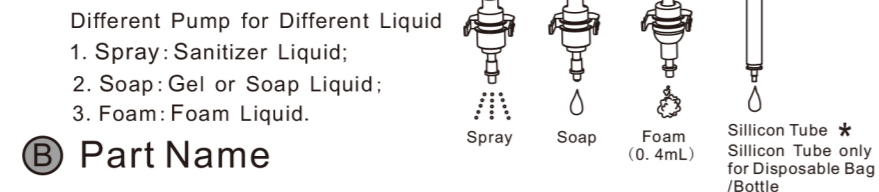
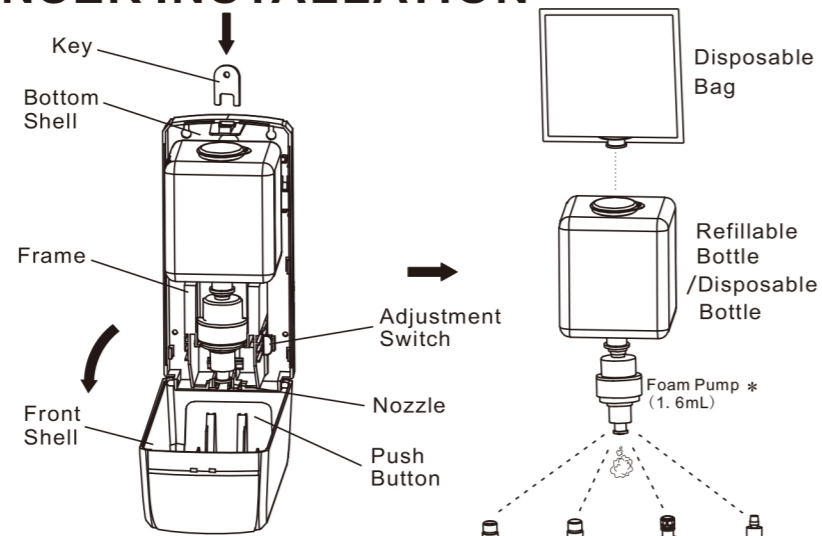

B Part Name

1. Drill hole (6mm Drill), and insert plug

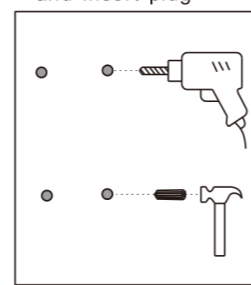

2. fix screw

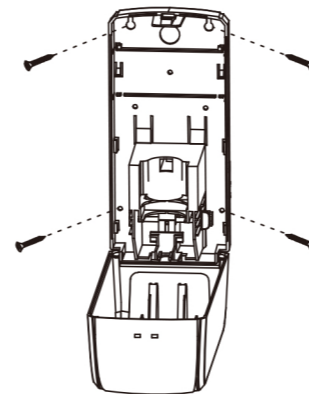

C Way for Screw

SENSOR FOAM SOAP DISPENSER INSTALLATION

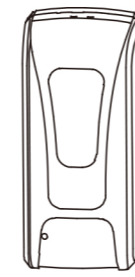

1X *



* we have different shape but same installation.

A Packing List

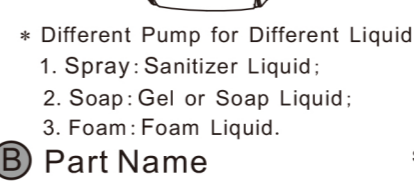
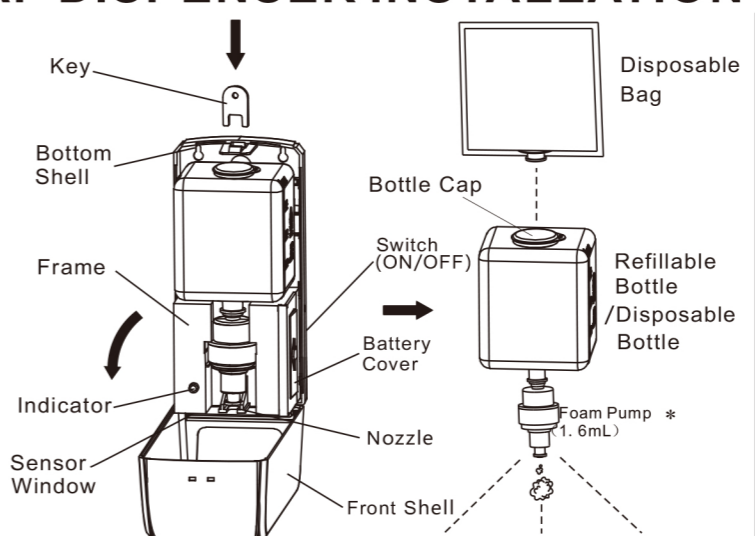

B Part Name

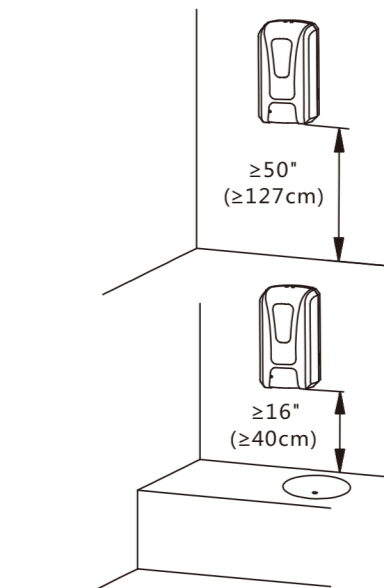

* keep away from sunshine and humid place

C Height from Floor/Table

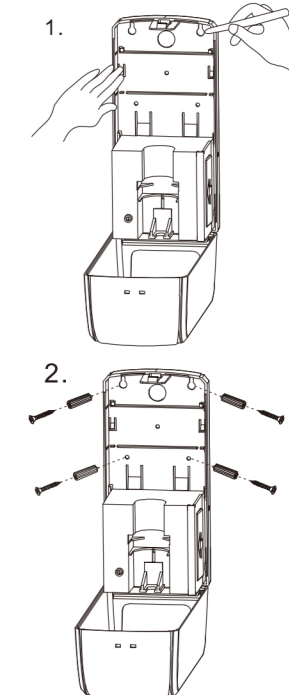

D Way for Screw

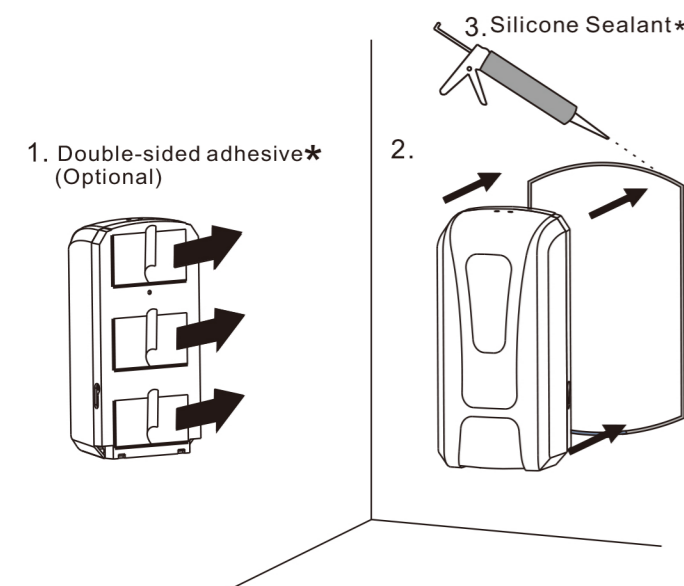

* The standard Packing is not including Double-sided adhesive and Silicone sealant

D Way for Sticker/without Screw

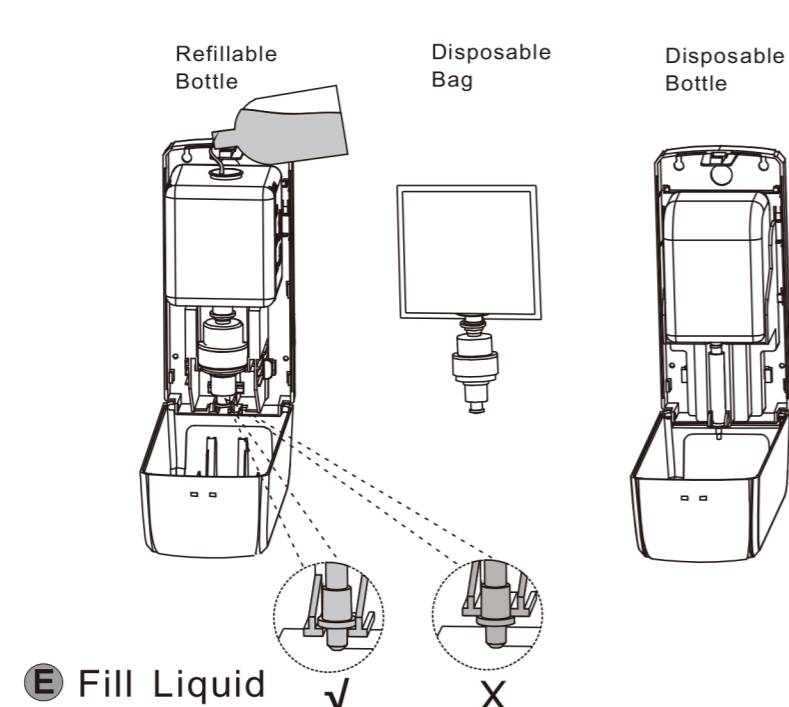

E Fill Liquid

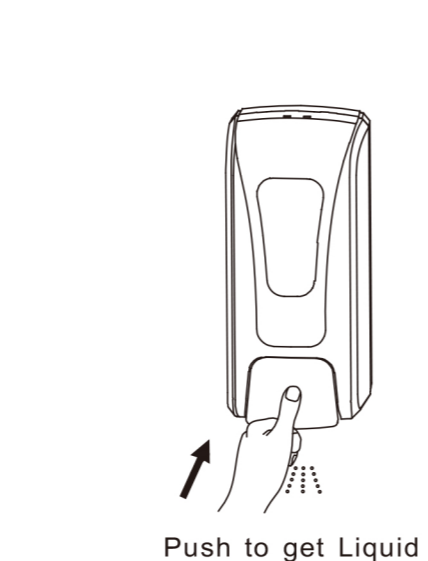

F Enjoy hand sanitizing

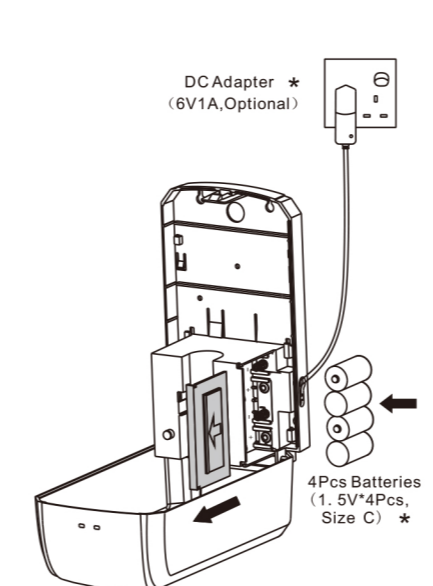

* The Standard Packing is not including DC Adapter and Batteries

E Install Batteries/DC Adapter

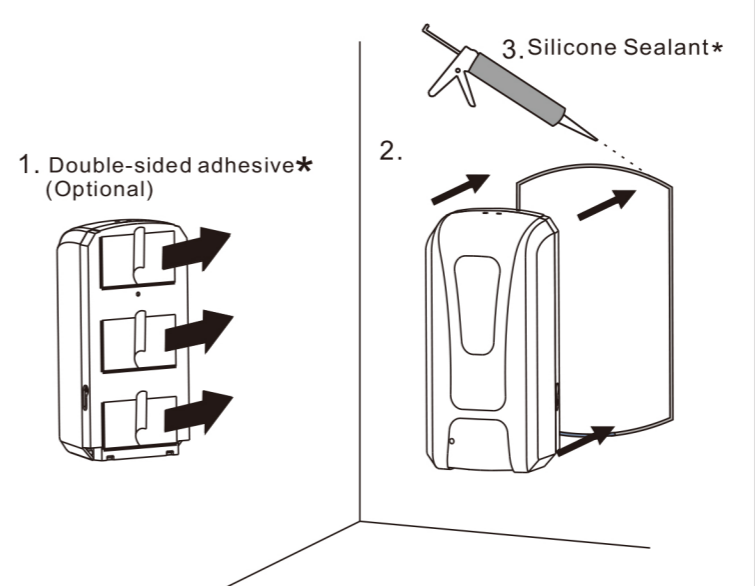

* The standard Packing is not including Double-sided adhesive and Silicone sealant

F Installation with Adhesive Backing (no screws)

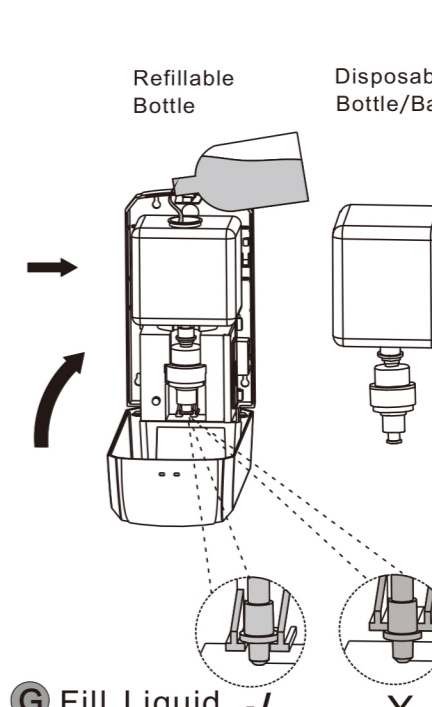

G Fill Liquid

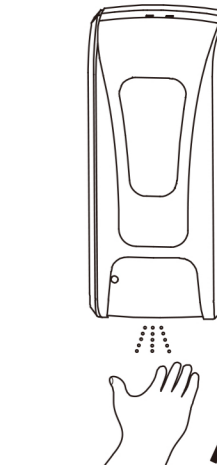

• UV disinfection
• LED Light:
1. green color 5 seconds flush: working condition;
2. red color 5 seconds flush: low power for battery and change;
3. red color 2 seconds flush: something under sensor and remove it;
• Sensing Distance: 8-12cm

H Enjoy hand sanitizing